



More than a system Luca Meda has designed an open score, a catalogue of options that govern rules and exceptions. This versatile programme is a flexible weave that can lend form to countless functional programmes. Order without monotony - the various materials, many finishes and service components are harmonious variations with which to bring the rhythm of our days to our space.

505 is now totally renewed, bearing witness to the flexibility and modular nature of the 505 system. Thanks to shelves of different thicknesses combined with doors with gloss or matte surface lacquer, in essence or in different colours of glass, it is now possible

to design new geometrical, high impact, functional compositions. With their precise movements, the sliding doors are patches of colour that open to reveal tidy compartments containing a host of different things, and perhaps our secret passions. Functional and rational, all the components are designed to house cables and wires. New glass doors with a modern aluminium profile have been added, to keep and at the same time display books and objects.

Home Theatre Case (HTC). An accessorised element, with no joints between containers and structure, to house television, Home Theatre system or Hi-Fi, hiding all cables.



**Luca Meda** is an important name in the history of Italian industry, and has contributed to the design culture of the Molteni Group with great passion. An example of harmonic partnership between creativity and business, art and industry. Almost a paradox for a designer who loves design and used the pencil more than any other instrument to describe and reinvent reality. Luca Meda was born in Chiavari by chance – his family spent their holidays there. He grew up and studied in Milan, graduating from the Brera Art School. He loved the centre of Milan and its urban landscape. Its monuments, its anonymous houses, the near invisible interiors and the good quality objects inside them all contributed to his emotional growth and development. He then studied in Germany, at the Hochschule für Gestaltung in Ulm, one of the most prestigious international design schools, founded in 1954 by Inge Scholl-Aicher and directed by Max Bill. His encounter with Aldo Rossi is a crucial moment. Together they opened a studio and took part in numerous competitions, such as that for the Contemporary History Museum in Milan. Since the late seventies, Luca Meda has been working on design and mass produced series. His main partnership is with the Molteni Group. His designs for Molteni & C. include a series of furnishings which are now considered icons, such as the Piroascafo bookcase designed with Aldo Rossi, the *Zim* and *Ho* chairs, the armchairs *Hi-Cove* and *Vivette* and the 505 programme. Meda has also created furnishing systems such as *Pass*, which allows the client to match simple and elegant open containers, sideboards, bookcases, benches and shelves, and 909, a flexible system of chests of drawers.

### ■ Finishes

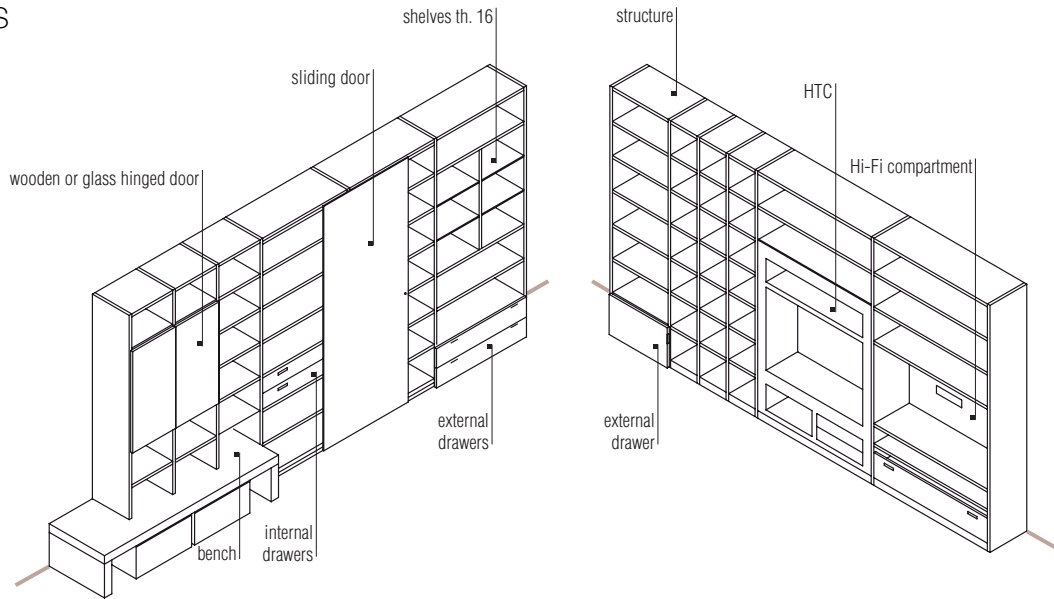

#### finishes

matt lacquer colours    glossy lacquer colours    woods    clear glass    coloured glass    semi-transparent glass    coloured etched glass    anodised aluminium    shiny aluminium

#### components

		matt lacquer colours	glossy lacquer colours	woods	clear glass	coloured glass	semi-transparent glass	coloured etched glass	anodised aluminium	shiny aluminium
structure and plinth										
bridges										
backs										
rear finishing panels										
internal drawers										
doors/external drawers with side handle										
glass door with side handle, hinged or sliding	trim									
	glass									
doors/external drawers with pressure opening										
doors/external drawers with handle										
glass door with handle	trim									
	glass									
wood sliding doors										
shelves										
tops										
HTC										
bench										

#### colours

##### Matt lacquer

BC chalk white  
AV ivory  
PE pearl  
AB alabaster  
DN dune  
PL platinum  
PB lead  
MK moka  
NE black  
RT venetian red  
BO bordeaux  
AM amber  
MZ aubergine  
NL hazelnut  
AT anthracite

##### Glossy lacquer

BC chalk white  
PE pearl  
DN dune  
PL platinum  
PB lead  
MK moka  
NE black  
RT venetian red  
BO bordeaux  
AM amber  
MZ aubergine  
AT anthracite

##### Woods

CN american walnut  
WE wengé  
RS dark oak  
RG grey oak  
  
VERTICAL grain for hinged doors with handle and side handle  
HORIZONTAL grain for hinged doors with pressure opening  
VERTICAL or HORIZONTAL grain for sliding doors aluminium.

##### Coloured glass / Glossy lacquer glass door trim

BC chalk white  
PE pearl  
DN dune  
PL platinum  
PB lead  
MK moka  
NE black  
RT venetian red  
BO bordeaux  
AM amber  
MZ aubergine  
AT anthracite

##### Semitransparent glass

SGR stopsol grey

##### Coloured etched glass

BC chalk white  
PE pearl  
DN dune  
PL platinum  
PB lead  
MK moka  
NE black  
RT venetian red  
BO bordeaux  
AM amber  
MZ aubergine  
RC powder pink  
NL hazelnut  
AT anthracite

Doors with etched glass finish will have automatically a trim in shiny aluminium.

### ■ Measurements

**Wall to wall widths:**

315 - 473 - 630 - 945 - 1260 mm + 28 mm for end piece  
 12 3/8" - 18 5/8" - 24 7/8" - 37 1/4" - 49 5/8" + 1 1/8"

**Heights:**

717 - 1037 - 1357 - 1677 - 1997 - 2317 - 2637 - 2957 mm  
 28 1/4" - 40 7/8" - 53 3/8" - 66" - 78 5/8" - 91 1/4" - 103 7/8" - 116 3/8"

**Structure depth:**

304 - 400 - 540 mm (12" - 15 3/4" - 21 1/4")

**Depth with hinged door and handle:**

327 - 423 - 563 mm (12 7/8" - 16 5/8" - 22 1/8")

**Depth with hinged door and pressure opening:**

313 - 409 - 549 mm (12 3/8" - 16 1/8" - 21 5/8")

**Depth with sliding door:**

320 - 416 - 556 mm (12 5/8" - 16 3/8" - 21 7/8")

**Depth with wooden/glass top:**

329 - 425 - 565 mm (13" - 16 3/4" - 22 1/4")

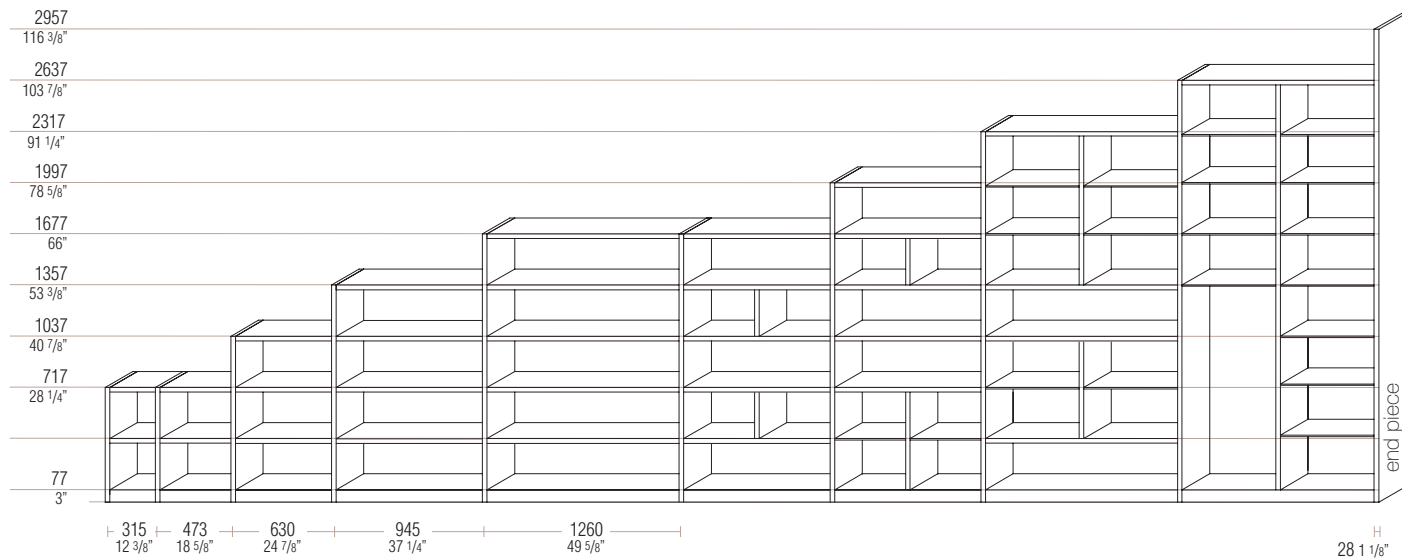

### ■ Handles

**Handles for doors and external drawers, handles for sliding door**

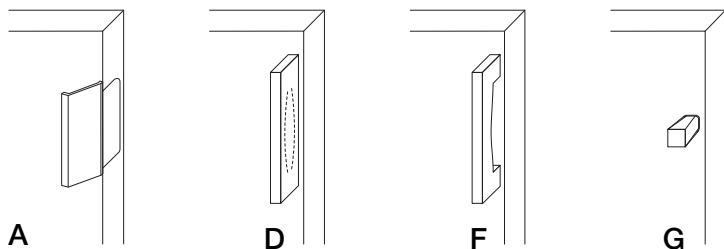

**A**  
 cannot be mounted on sliding door and on glossy lacquer finished

**FINISHES**

**A:** anodised aluminium, shiny chrome, black chrome

**D F:** acetate with shiny finish: chalk white, pearl, black

**G:** acetate with shiny finish: chalk white, pearl, black, chrome calce, perla, nero, cromo

**Doors and external drawers with side handle**



**Pressure opening**

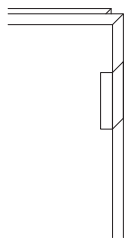

**Sunken handle for internal drawers**

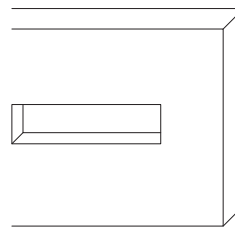

### Unit subdivisions

Units 1260 (49 5/8"), 945 (37 1/4") and 630 mm (24 7/8") side can be subdivided in width using central partitions.

With a depth of 540 (21 1/4") the spaces cannot be sub-divided.

A unit subdivided by central partition can be designed with or without the back panel. The back panel can be separated by height but not by width (see example 1).

When the central partition is between two shelves width 945 (37 1/4") and 1231 (48 1/2") or between a shelf and the top shelf, the lower of the two shelves must be reinforced (see part. A).

The compartments obtained may include shelves th. 28 mm (1 1/8") and shelves th. 16 mm (5/8").

The units created may contain exterior drawers. A unit suspended between two shelves can have drawers with maximum height of two modules and must always have, for units with width 945 (37 1/4") and 1260 (49 5/8"), a central supporting partition in the lower part (see part. B) or a lower reinforced structural shelf with interruption in the back (part. C).

In case a subdivision is placed at the height of 1997, no ladder can be fitted.

The central partition of the subdivision can only be reduced in height.

Hinged doors may be hinged to central divider pieces.

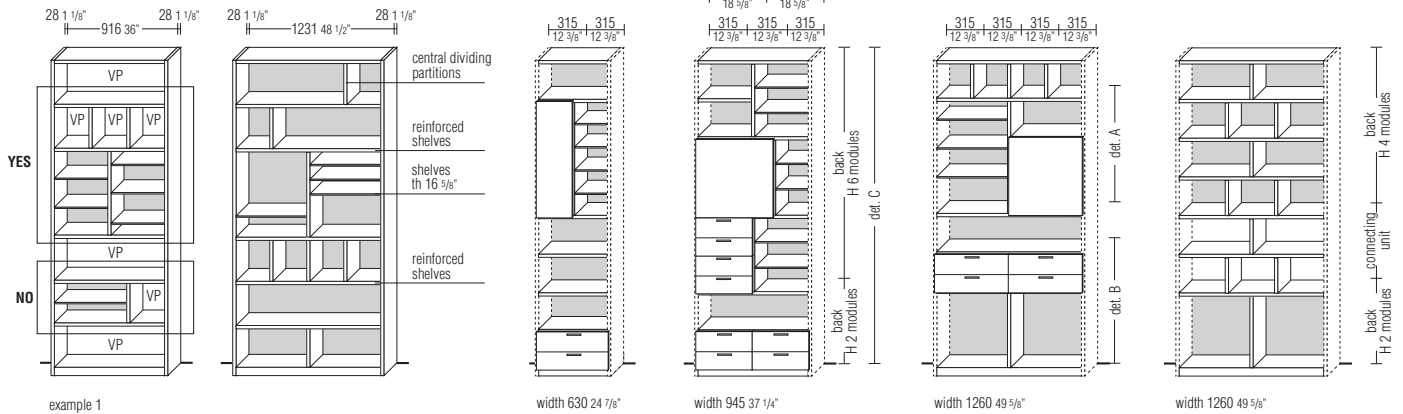

### Different depths

single composition

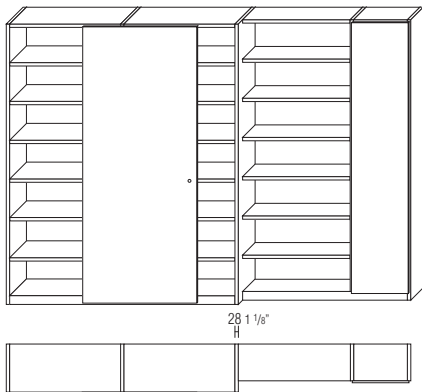

2 compositions

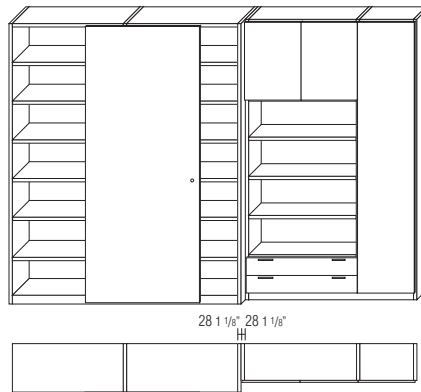

Only when the unit with the smallest depth has doors or external drawers a double side panel is necessary. **A glass top cannot be used if there is a depth difference.**

### Different heights

single composition

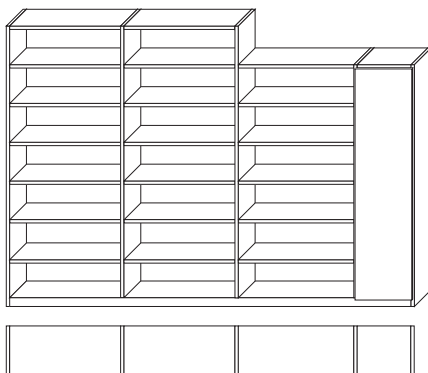

Only when the lower height require a wooden top, a double side panel is necessary. A glass top cannot be used if there is a height difference.

### Bridges

Bridge shelf use in structures

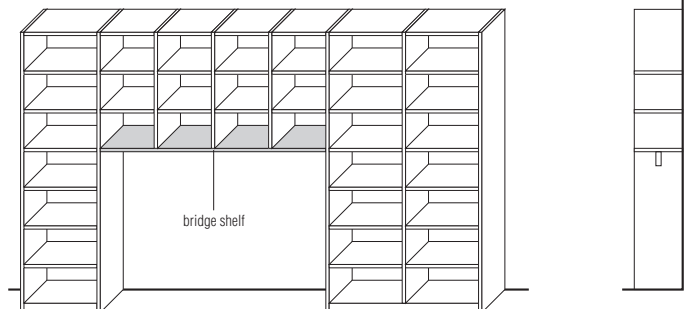

The bridge bar code TR must be used in addition to the bridge shelf.

## ■ Hi-Fi compartment

d. 400 mm - for compartments w. 945 and w. 1260 mm  
available for minimum height of composition: 1357 mm + top and 1677 mm + top

### Version with TV mount

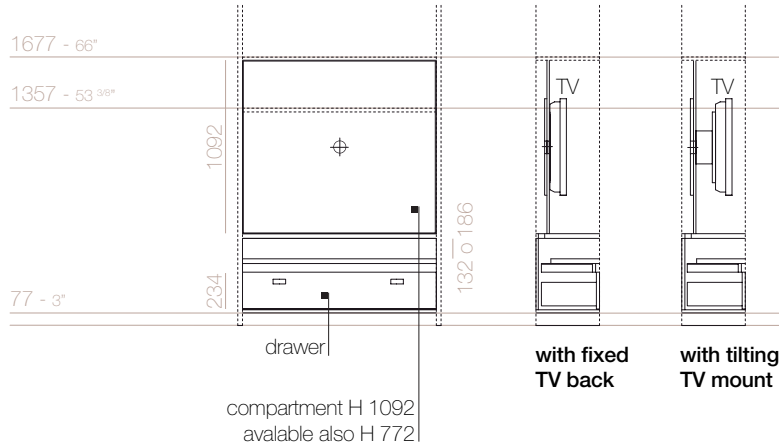

### Version with standing TV compartment

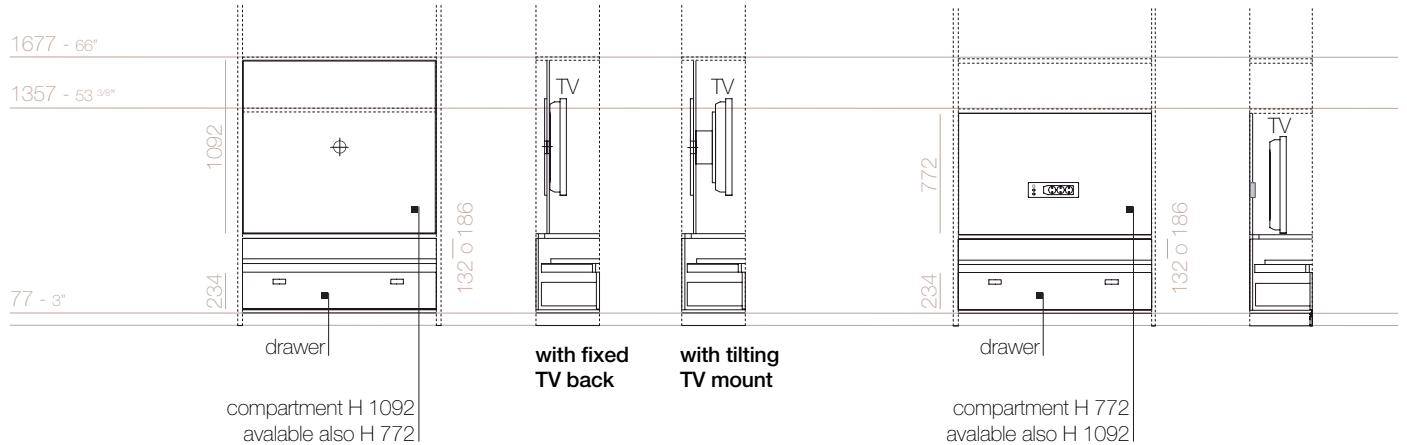

## ■ HTC (Home Theatre Case)

d. 400 mm - for compartments w. 1260 mm

### tall HTC

available for minimum height of composition  
1677 mm + top

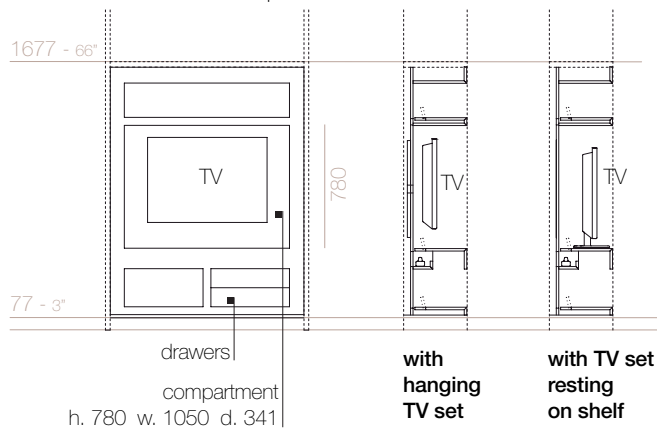

### low HTC

available for minimum height of composition  
1357 mm + top

